

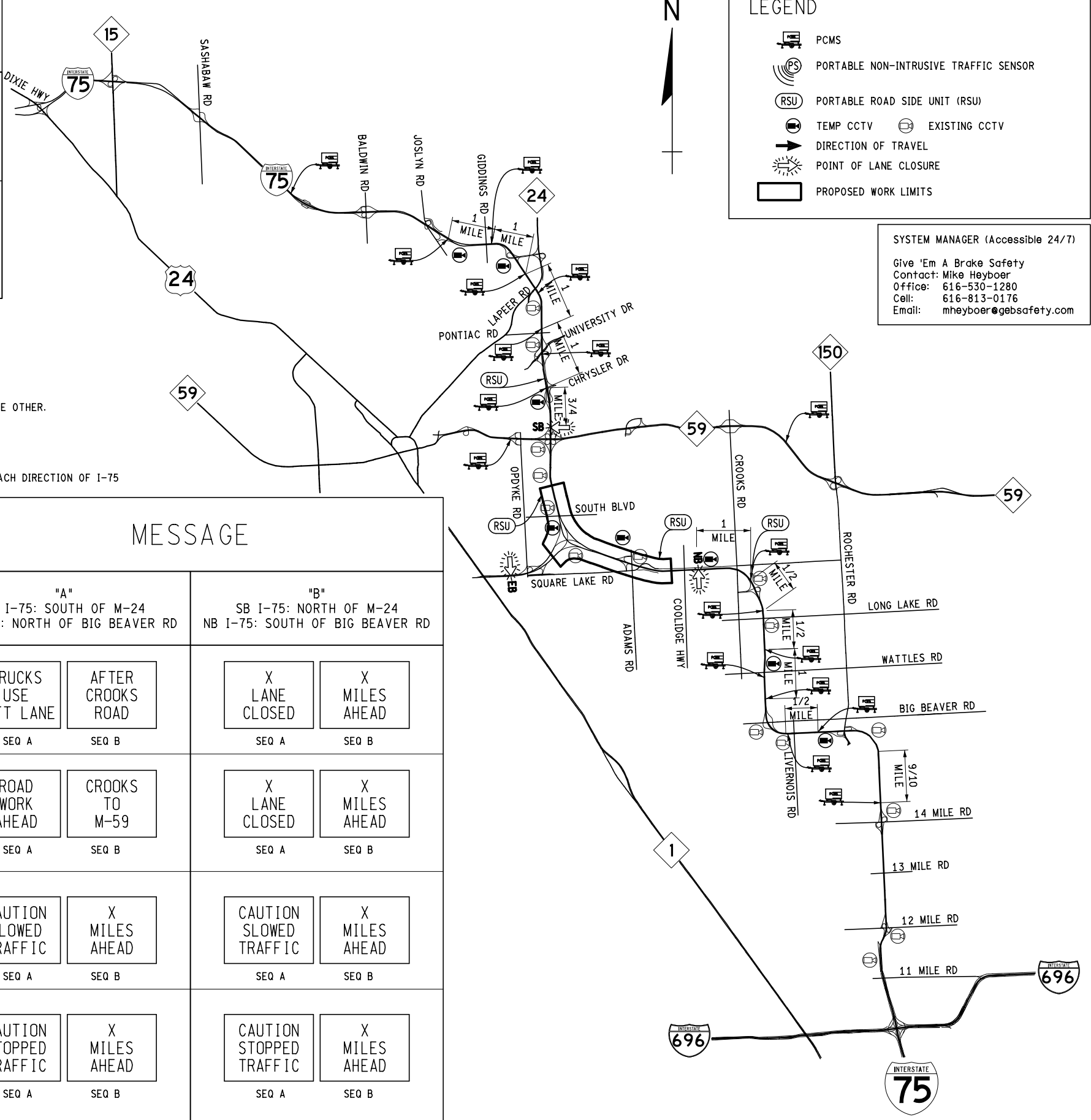

SCENARIO	PERIODIC MESSAGE
NO QUEUE NORMAL	<div style="display: flex; justify-content: space-around;"> <div style="border: 1px solid black; width: 40px; height: 40px; margin: 2px;"></div> <div style="border: 1px solid black; width: 40px; height: 40px; margin: 2px;"></div> </div> <p style="text-align: center;">SEQ A      SEQ B</p>
NORMAL "A" MESSAGES	<div style="display: flex; justify-content: space-around;"> <div style="border: 1px solid black; padding: 2px; width: 40px; height: 40px; text-align: center;">TRUCKS USE LEFT LANE</div> <div style="border: 1px solid black; padding: 2px; width: 40px; height: 40px; text-align: center;">AFTER CROOKS ROAD</div> </div> <p style="text-align: center;">SEQ A      SEQ B</p>

**NOTES TO CONTRACTOR:**

1. ADJUST RTWZTMS DEVICES AS NEEDED THROUGHOUT CONSTRUCTION.
2. SPACE PORTABLE TRAFFIC SENSORS 1/4 MILE TO 1/2 MILE APART.
3. SPACE PCMS 1/2 TO 1 MILE APART. STAGGER PCMS FROM ONE SIDE OF THE ROAD TO THE OTHER.
4. PLACE CCTV TO PROVIDE MAXIMUM VIEWING OF POTENTIAL BACKUPS.
5. USE 18 NTCIP-COMPLIANT PCMS, 28 PORTABLE TRAFFIC SENSORS, AND 8 CCTV.
6. PLACE 1 PCMS IN EACH DIRECTION ON M-59 IN ADVANCE OF I-75. PLACE 8 PCMS IN EACH DIRECTION OF I-75 IN ADVANCE OF THE WORK ZONE.
7. DEPLOY FOUR (4) PORTABLE RSU'S AT LOCATIONS WITHIN THE WORK ZONE AND APPROACHES AS DEFINED BY THE MDT PROJECT MANAGER. RELOCATE THE PORTABLE RSU'S THROUGHOUT THE CONSTRUCTION PERIOD AS DIRECTED BY THE MDT PROJECT MANAGER. THE FOUR (4) PORTABLE RSU'S ARE INDEPENDENT FROM THE STOPPED TRAFFIC ADVISORY SYSTEM.



**LEGEND**

- PCMS
- PORTABLE NON-INTRUSIVE TRAFFIC SENSOR
- PORTABLE ROAD SIDE UNIT (RSU)
- TEMP CCTV      EXISTING CCTV
- DIRECTION OF TRAVEL
- POINT OF LANE CLOSURE
- PROPOSED WORK LIMITS

SYSTEM MANAGER (Accessible 24/7)  
 Give 'Em A Brake Safety  
 Contact: Mike Heyboer  
 Office: 616-530-1280  
 Cell: 616-813-0176  
 Email: mheyboer@gebsafety.com

SCENARIO	THRESHOLD (MPH)	MESSAGE			
		"A" SB I-75: SOUTH OF M-24 NB I-75: NORTH OF BIG BEAVER RD		"B" SB I-75: NORTH OF M-24 NB I-75: SOUTH OF BIG BEAVER RD	
NO QUEUE	>= 70	<div style="display: flex; justify-content: space-around;"> <div style="border: 1px solid black; padding: 2px; width: 40px; height: 40px; text-align: center;">TRUCKS USE LEFT LANE</div> <div style="border: 1px solid black; padding: 2px; width: 40px; height: 40px; text-align: center;">AFTER CROOKS ROAD</div> </div> <p style="text-align: center;">SEQ A      SEQ B</p>	<div style="display: flex; justify-content: space-around;"> <div style="border: 1px solid black; padding: 2px; width: 40px; height: 40px; text-align: center;">X LANE CLOSED</div> <div style="border: 1px solid black; padding: 2px; width: 40px; height: 40px; text-align: center;">X MILES AHEAD</div> </div> <p style="text-align: center;">SEQ A      SEQ B</p>		
NORMAL	50 TO 69	<div style="display: flex; justify-content: space-around;"> <div style="border: 1px solid black; padding: 2px; width: 40px; height: 40px; text-align: center;">ROAD WORK AHEAD</div> <div style="border: 1px solid black; padding: 2px; width: 40px; height: 40px; text-align: center;">CROOKS TO M-59</div> </div> <p style="text-align: center;">SEQ A      SEQ B</p>	<div style="display: flex; justify-content: space-around;"> <div style="border: 1px solid black; padding: 2px; width: 40px; height: 40px; text-align: center;">X LANE CLOSED</div> <div style="border: 1px solid black; padding: 2px; width: 40px; height: 40px; text-align: center;">X MILES AHEAD</div> </div> <p style="text-align: center;">SEQ A      SEQ B</p>		
SLOW TRAFFIC	21 TO 49	<div style="display: flex; justify-content: space-around;"> <div style="border: 1px solid black; padding: 2px; width: 40px; height: 40px; text-align: center;">CAUTION SLOWED TRAFFIC</div> <div style="border: 1px solid black; padding: 2px; width: 40px; height: 40px; text-align: center;">X MILES AHEAD</div> </div> <p style="text-align: center;">SEQ A      SEQ B</p>	<div style="display: flex; justify-content: space-around;"> <div style="border: 1px solid black; padding: 2px; width: 40px; height: 40px; text-align: center;">CAUTION SLOWED TRAFFIC</div> <div style="border: 1px solid black; padding: 2px; width: 40px; height: 40px; text-align: center;">X MILES AHEAD</div> </div> <p style="text-align: center;">SEQ A      SEQ B</p>		
STOPPED TRAFFIC	< 21	<div style="display: flex; justify-content: space-around;"> <div style="border: 1px solid black; padding: 2px; width: 40px; height: 40px; text-align: center;">CAUTION STOPPED TRAFFIC</div> <div style="border: 1px solid black; padding: 2px; width: 40px; height: 40px; text-align: center;">X MILES AHEAD</div> </div> <p style="text-align: center;">SEQ A      SEQ B</p>	<div style="display: flex; justify-content: space-around;"> <div style="border: 1px solid black; padding: 2px; width: 40px; height: 40px; text-align: center;">CAUTION STOPPED TRAFFIC</div> <div style="border: 1px solid black; padding: 2px; width: 40px; height: 40px; text-align: center;">X MILES AHEAD</div> </div> <p style="text-align: center;">SEQ A      SEQ B</p>		

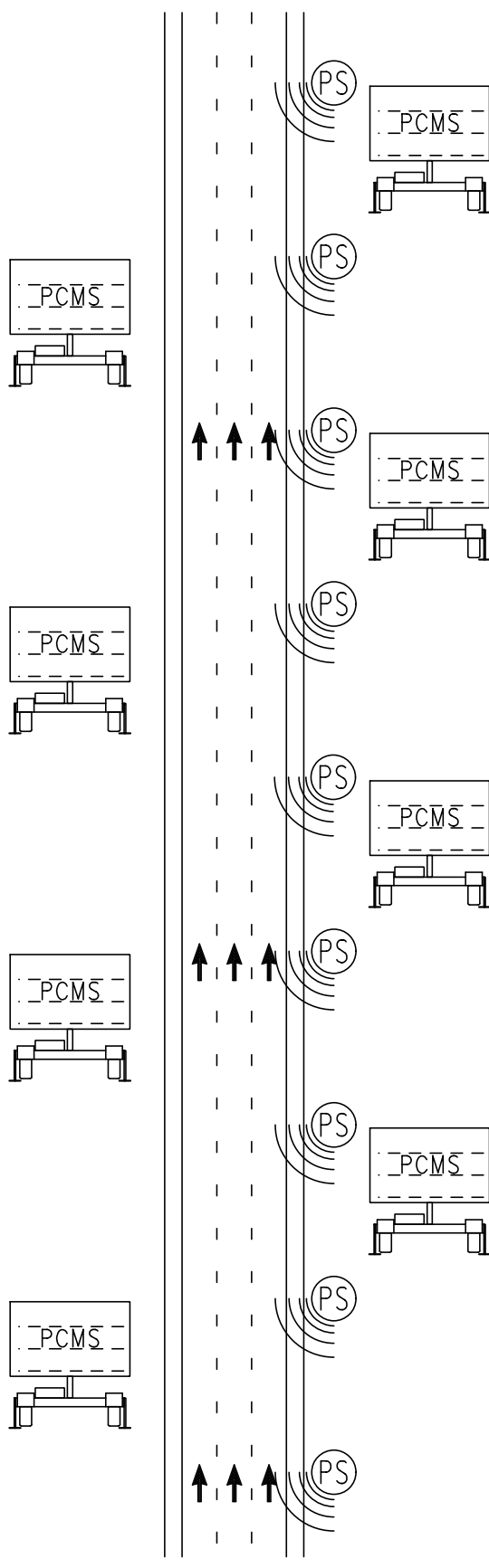

**LEGEND**

- PCMS
- PORTABLE NON-INTRUSIVE TRAFFIC SENSOR
- PORTABLE ROAD SIDE UNIT (RSU)
- TEMP CCTV
- EXISTING CCTV
- DIRECTION OF TRAVEL
- POINT OF LANE CLOSURE
- PROPOSED WORK LIMITS

SYSTEM MANAGER (Accessible 24/7)  
 Give 'Em A Brake Safety  
 Contact: Mike Heyboer  
 Office: 616-530-1280  
 Cell: 616-813-0176  
 Email: mheyboer@gebsafety.com



NOTE:  
 KEEP PCMS AND SENSORS IN SAME LOCATION WHEN CLOSING THE FREEWAY.  
 TURN OFF SENSORS PAST CROOKS FOR NORTHBOUND TRAFFIC AND PAST  
 M-59 FOR SOUTHBOUND TRAFFIC AND READJUST MESSAGING.

- NOTES TO CONTRACTOR:
- ADJUST RTWZTMS DEVICES AS NEEDED THROUGHOUT CONSTRUCTION.
  - SPACE PORTABLE TRAFFIC SENSORS 1/4 MILE TO 1/2 MILE APART.
  - SPACE PCMS 1/2 TO 1 MILE APART. STAGGER PCMS FROM ONE SIDE OF THE ROAD TO THE OTHER.
  - SPACE CCTV 1 TO 2 MILES APART. ADJUST TO PROVIDE MAXIMUM VIEWING OF POTENTIAL BACKUPS.
  - USE 18 NTCIP-COMPLIANT PCMS, 28 PORTABLE TRAFFIC SENSORS, AND 8 CCTV.
  - DEPLOY FOUR (4) PORTABLE RSU'S AT LOCATIONS WITHIN THE WORK ZONE AND APPROACHES AS DEFINED BY THE MDT PROJECT MANAGER. RELOCATE THE PORTABLE RSU'S THROUGHOUT THE CONSTRUCTION PERIOD AS DIRECTED BY THE MDT PROJECT MANAGER. THE FOUR (4) PORTABLE RSU'S ARE INDEPENDENT FROM THE STOPPED TRAFFIC ADVISORY SYSTEM.

SCENARIO	THRESHOLD (MPH)	MESSAGE
NO QUEUE	$\geq 70$	<div style="display: flex; justify-content: space-around;"> <div style="border: 1px solid black; padding: 2px;">TRUCKS USE LEFT LANE SEQ A</div> <div style="border: 1px solid black; padding: 2px;">AFTER CROOKS ROAD SEQ B</div> </div>
NORMAL	50 TO 69	<div style="display: flex; justify-content: space-around;"> <div style="border: 1px solid black; padding: 2px;">FREEWAY CLOSED AT CROOKS SEQ A</div> <div style="border: 1px solid black; padding: 2px;">FOLLOW DETOUR SEQ B</div> </div>
SLOW TRAFFIC	21 TO 49	<div style="display: flex; justify-content: space-around;"> <div style="border: 1px solid black; padding: 2px;">CAUTION SLOWED TRAFFIC SEQ A</div> <div style="border: 1px solid black; padding: 2px;">FREEWAY CLOSED AHEAD SEQ B</div> </div>
STOPPED TRAFFIC	$< 21$	<div style="display: flex; justify-content: space-around;"> <div style="border: 1px solid black; padding: 2px;">CAUTION STOPPED TRAFFIC SEQ A</div> <div style="border: 1px solid black; padding: 2px;">FREEWAY CLOSED AHEAD SEQ B</div> </div>

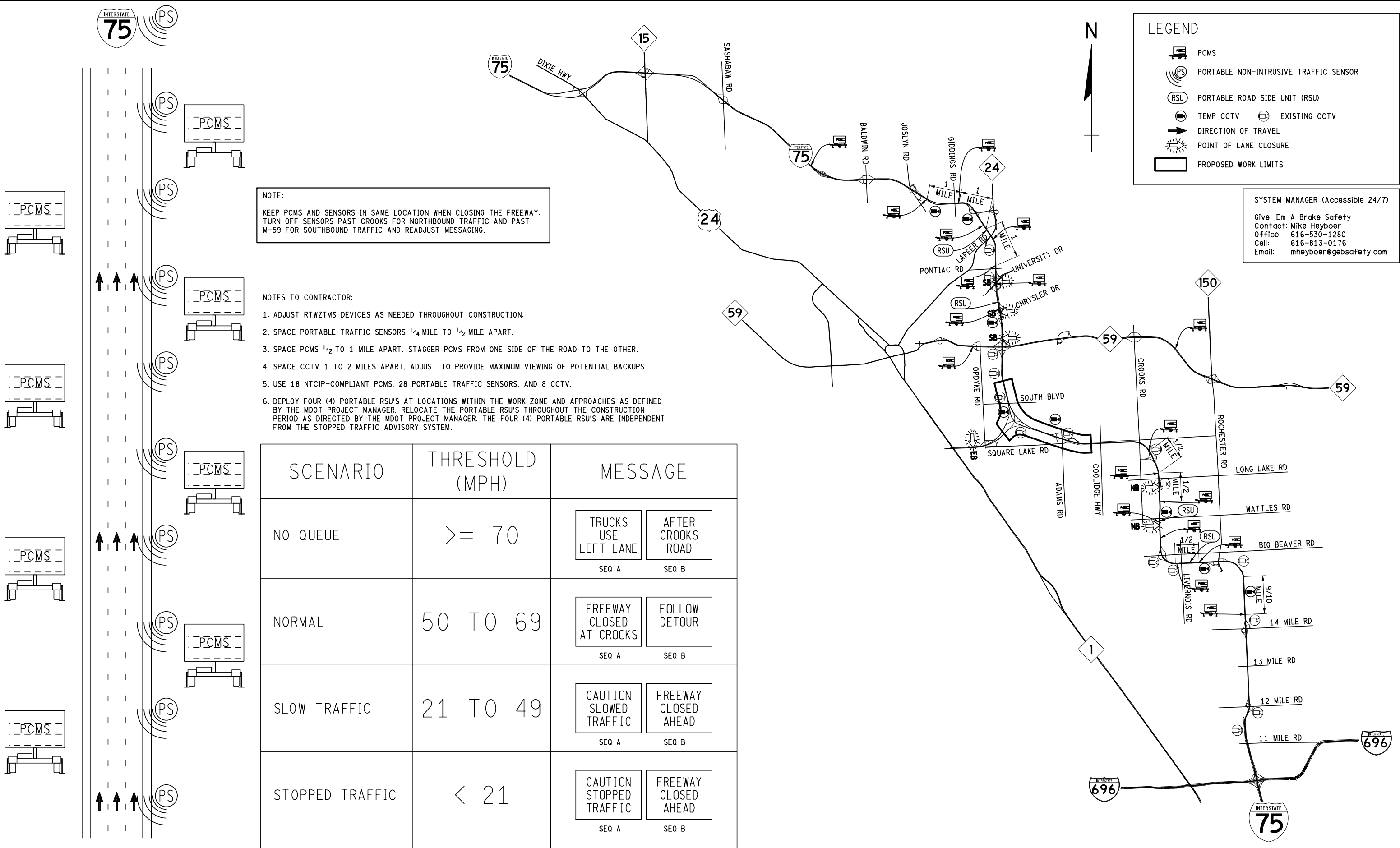

FINAL ROW PLAN REVISIONS		(SUBMITTAL DATE: )	
NO.	DATE	AUTH	DESCRIPTION



**NO SCALE**

DATE: 8/8/2016  
 DESIGN UNIT: DATTA  
 FILE: 115576\_MTSDET003\_STAS\_FWY\_CL.DWG

CS: 63174  
 JN: 115576

MAINTAINING TRAFFIC SHEET  
 STOPPED TRAFFIC ADVISORY SYSTEM  
 RTWZTMS - FREEWAY CLOSURE

DRAWING SHEET  
 I-75  
 MOT  
 3  
 SECT 1  
 3